



Specifications and technical data are subject to change without notice.  
Please contact to confirm relevant information on ordering.

**Ebasee**  
Smart Living Green Ebasee



**CONTROL ELECTRIC**



Copy right reserved EBS.NO.2021001

📍 No.18, Gutang Rd, Shanghai 201209, China  
☎ +86 21 5032 0898  
📠 +86 21 5032 0828  
✉ info@ebasee.com  
🌐 www.ebasee.com





# COMPANY PROFILE

As a leading supplier in the low voltage electrics industry, Shanghai Ebasee Electric Co., Ltd. products have been used for residential, commercial and industrial applications with its quality and service. EBASEE brand is recognized for its quality and reliability in an ever-increasing number of markets worldwide. So far EBASEE products have been approved by international labs including BV, TUV, Intertek, with KEMA, CB, SEMKO, RoHS, CE, and CCC etc.

With qualified raw materials and components supply, all products are manufactured by EBASEE's defined international specifications. We have 4 semi-auto production lines, up-to-date quality control facilities, well-trained and experienced workers. Moreover, with a technical R & D team and fully equipped in-house laboratory, EBASEE factory can carry out efficient new products development, daily production and QC.

EBASEE have a wide range of cooperations with world leading companies in new products development, OEM and ODM cooperation. Meanwhile, we process the idea of green and smart energy, working with universities such as Xi'an Jiao Tong University to get more intelligent and environmental electric solutions.

EBASEE focused on achieving growth through the success of worldwide partners. Guided by the philosophy of "market-oriented", powered by the idea of "Quick response and flexible supply", EBASEE support our worldwide partners to compete against established global players, to deliver the most systematic and cost-effective products and service in the market.

"Smart life, Green EBASEE"



Quality is our culture!

## PRODUCTION LINE

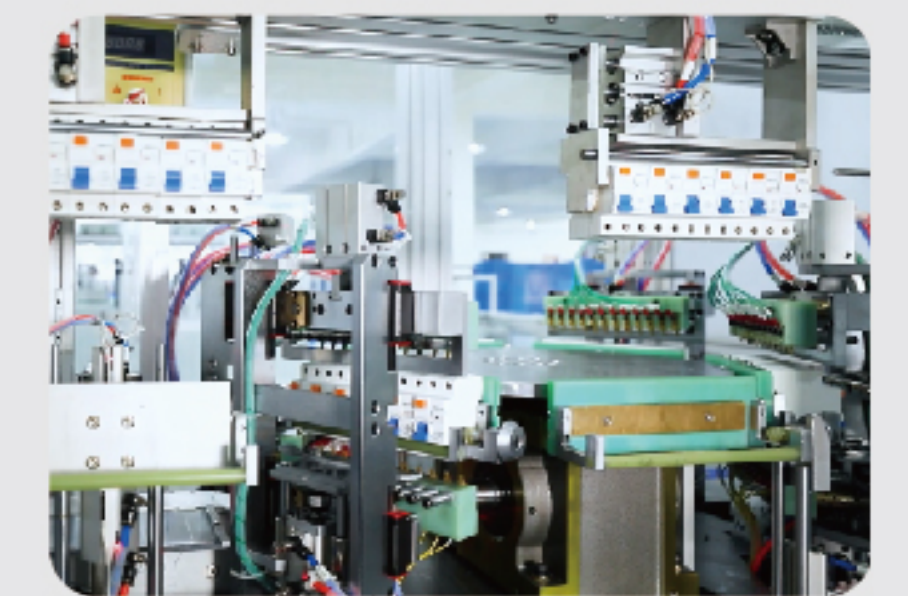



# SMART LIVING GREEN EBASEE



## INTERNATIONAL QUALITY CERTIFICATE

EBASEE products have been approved by international labs including BV, TUV, Intertek, with KEMA, CB, SEMKO, RoHS, CE, and CCC etc.

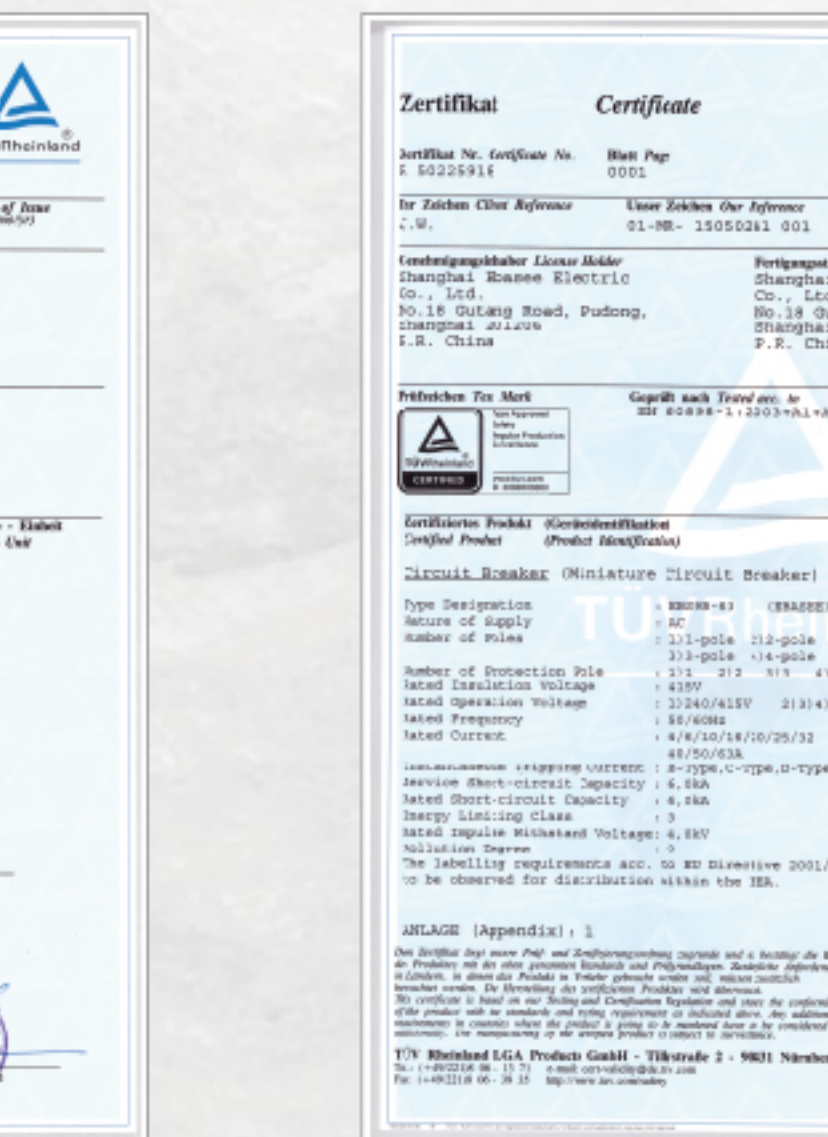
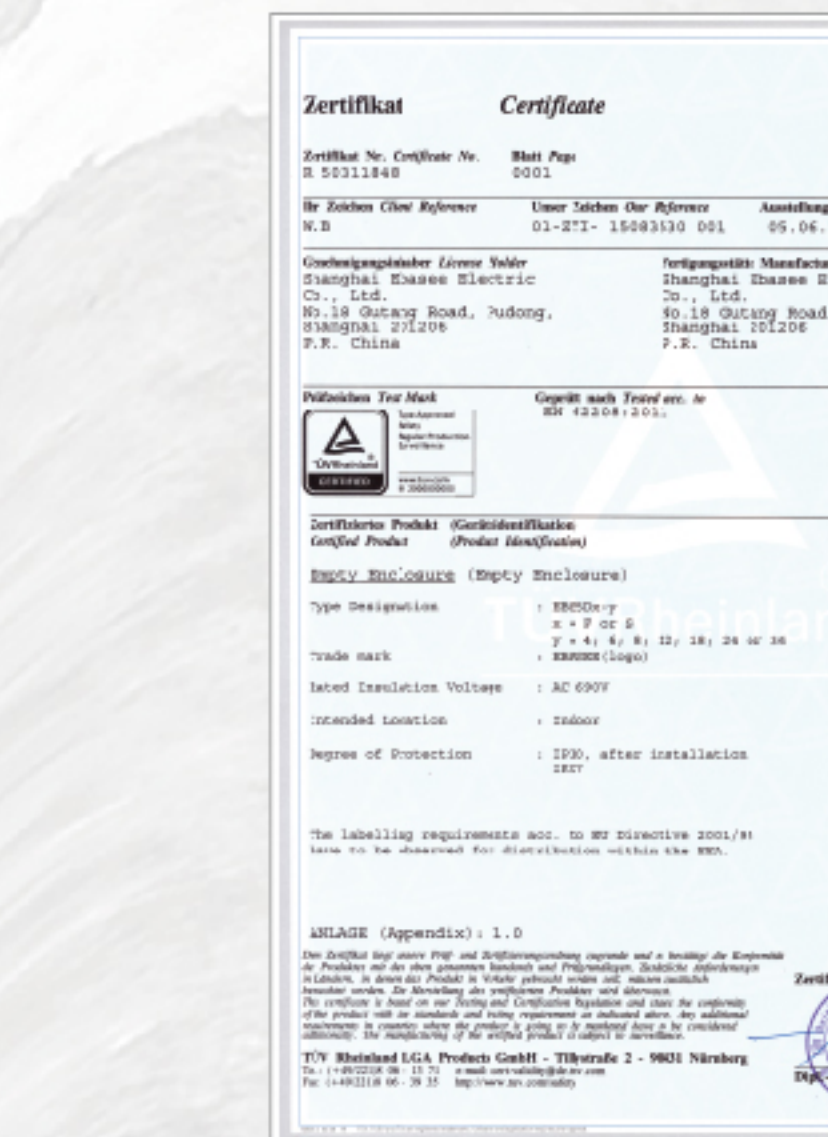
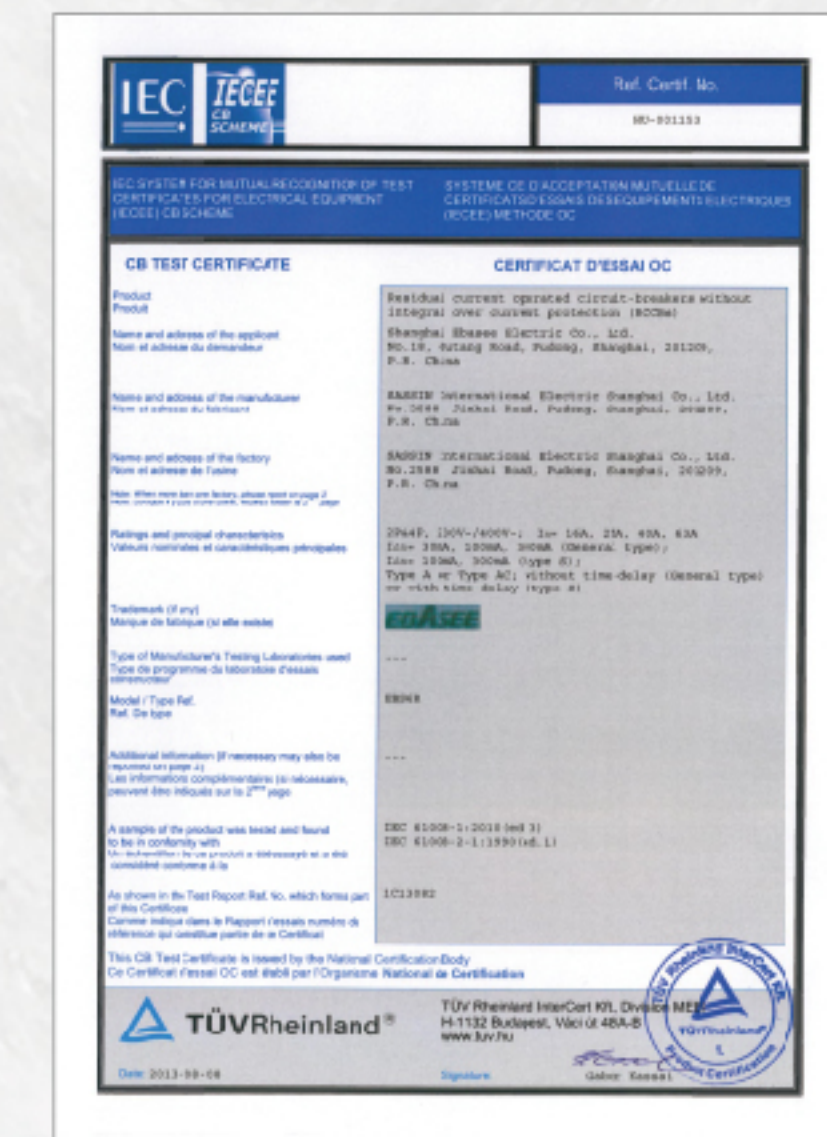
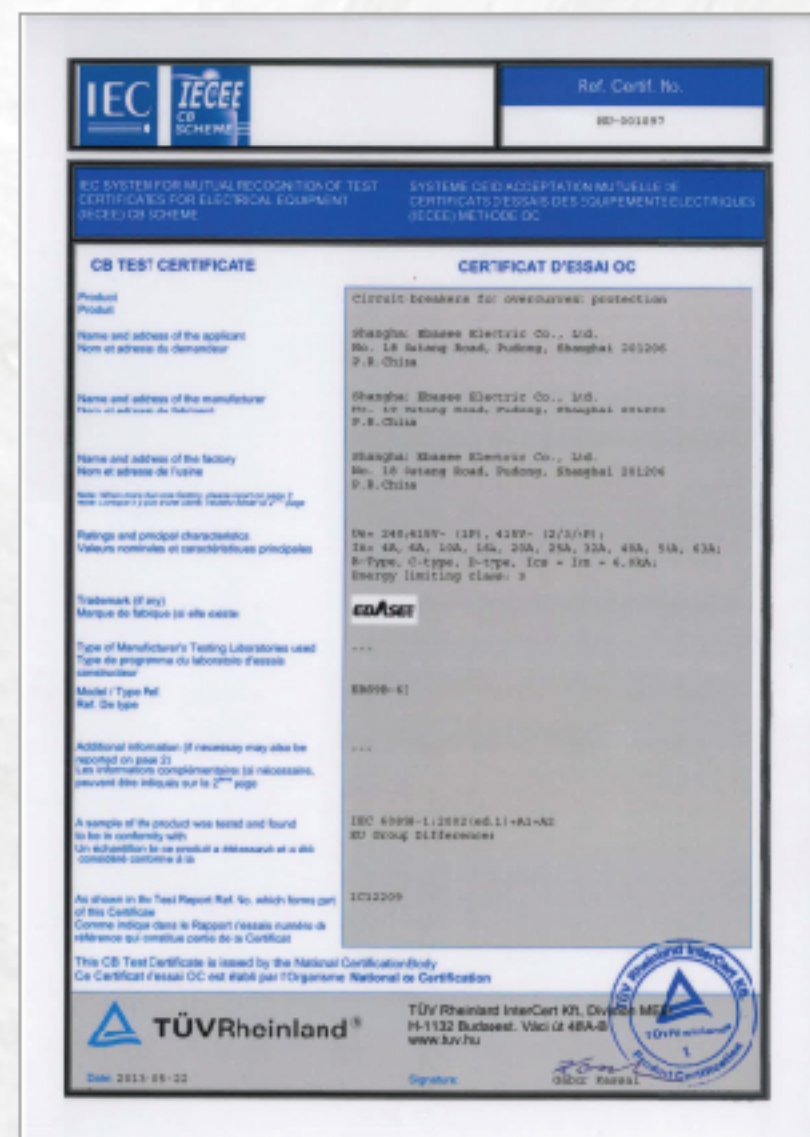



### 1.General

This series fuse body applied to AC 50Hz, rated insulation voltage to 690V, rated current 125A, it mainly as a electrical circuit overload and short circuit protection (gG), can also be derived for semiconductor devices and its complete sets of equipment of short circuit protection (aR) and motor short circuit protection (aM).  
With high breaking capacity to 100kA  
This series fuse conforms to IEC60269.



### 2.Structure Feature

It made of pure copper/silver piece (or silk) melt encapsulation and high strength porcelain or epoxy glass cloth of fuse tube; Fuse tube is filled with the chemical impactor, when fusing body fuse, impactor immediately action, promote the micro switch, signal of various goods automatic switching circuit.  
This series of fuse body assumes the plug-in structure, according to the size can be installed in the RT14, RT18, RT19 and other appropriate size fuse support

### 3.Dimensions

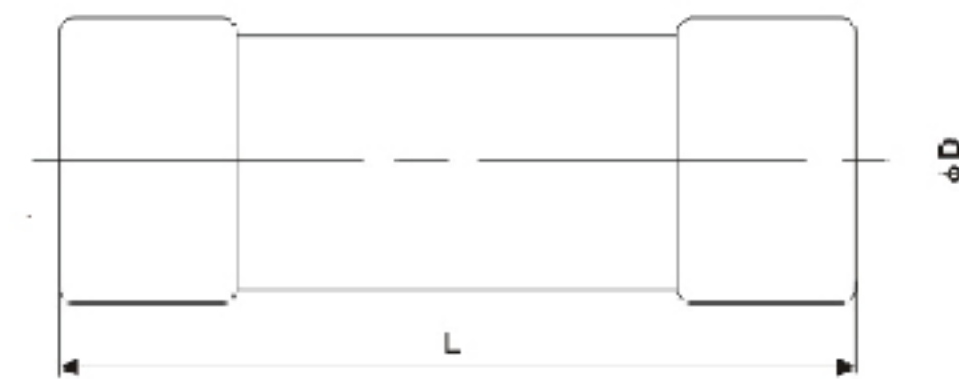

Drawing 3.1

### 4.Specifications

NO.	Model of fues link				Rated voltage(V)	Rated current(A)	Weight (g)	Drawing No.	Overall dimension /size(mm) φD*L
	The company		Domestic and oversea similar products						
	General (Gg)	Quick speed (aR)	General (Gg)	Quick speed (aR)					
12148	RO06	RS06	-	-	250/380	1~32	6.5	3.1	φ12.7×29
12149	RO07	RS07	-	-	600	10~100	75	3.1	φ30×57
12150	RO09	RS09	-	-	500	2~63	17.4	3.1	φ18×37
12151	RO10	RS10	-	-	500	2~63	23.5	3.1	φ18×50
12152	RO11	RS11	AJT JKS LPJ	ACL	600	2~32	51.5	3.1	φ21×58
12153	RO12	RS12	AJT JKS LPJ	ACL	600	35~100	90	3.1	φ27×60
12154	RO13	RS13	-	-	500	2~40	23.2	3.1	φ15×50
12155	RO14	RS14	RT19-16gF1	-	500	0.5~20	4.4	3.1	φ8.5×31.5
12156	RO14A	RS14A	-	-	250	0.5~20	3.5	3.1	φ8.5×23
12157	RO14B	RS14B	-	-	380/500	0.5~20	5.0	3.1	φ8.5×36
12158	RO15	RS15	RT14-20gF2 RT18-32 RT19-25	KTK KLM	380/500	0.5~32	7.7	3.1	φ10.3×38
12159	RO15A	RS15A	-	-	250	0.5~16	4.8	3.1	φ10.3×25.8
12160	RO15B	RS15B	-	-	250/500	0.5~25	5.8	3.1	φ10.3×31.5
12161	RO15C	RS15C	-	-	380/500	0.5~32	6.2	3.1	φ10.3×34
12162	RO15D	RS15D	-	-	600	2~32	11	3.1	φ10.3×57
12163	RO16	RS16	RT14-32gF3 RT18-63 RT19-40	EWP	380/660	2~50	20.5	3.1	φ14.3×51
12164	RO16A	RS16A	-	-	500	2~50	15.6	3.1	φ14.3×38
12165	RO16B	RS16B	-	-	500	2~50	18.5	3.1	φ14.3×45
12166	RO16C	RS16C	-	-	500	2~50	27.5	3.1	φ14.3×67
12167	RO17	RS17	RT14-63gF4 RT18-125 RT19-100	URE2263	380/660	10~125	58	3.1	φ22.2×58
12168	RO18	RS18	-	-	380	0.5~25	4.8	3.1	φ9.6×30
12169	RO19	RS19	FRS TRS FLSR	-	600	0.5~32	91.2	3.1	φ20.5×127
12170	RO19A	RS19A	FLNR PC2	-	250/500	0.5~63	63	3.1	φ20.5×76
12171	RO19B	RS19B	-	-	600	0.5~32	85	3.1	φ20.5×114
12172	RO19C	RS19C	FRS TRS FLSR	-	600	32~63	172.4	3.1	φ27×139
12173	RO19D	RS19D	-	-	600	32~63	160	3.1	φ27×147
12174	RO54	RS54	-	-	250	0.5~16	1	3.1	φ5×20
12175	RO55	RS55	-	-	250	0.5~16	1.3	3.1	φ5×25
12176	RO56	RS56	-	-	250	0.5~16	1.7	3.1	φ6×20
12177	RO57	RS57	-	-	250	0.5~16	2.1	3.1	φ6.3×25
12178	RO58	RS58	-	-	250/500	0.5~16	2.5	3.1	φ6.3×31.5



## 5.Characteristic Curve

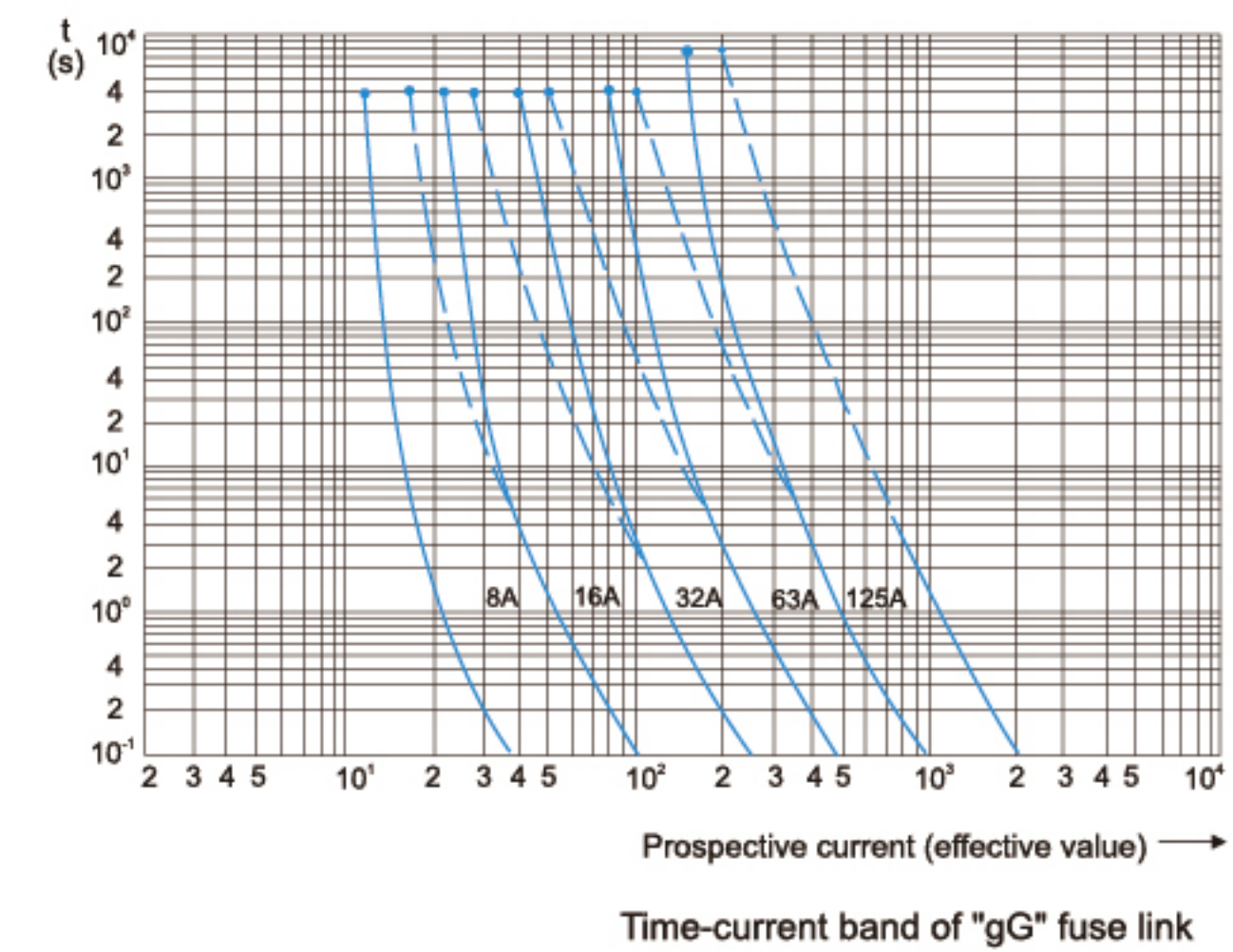
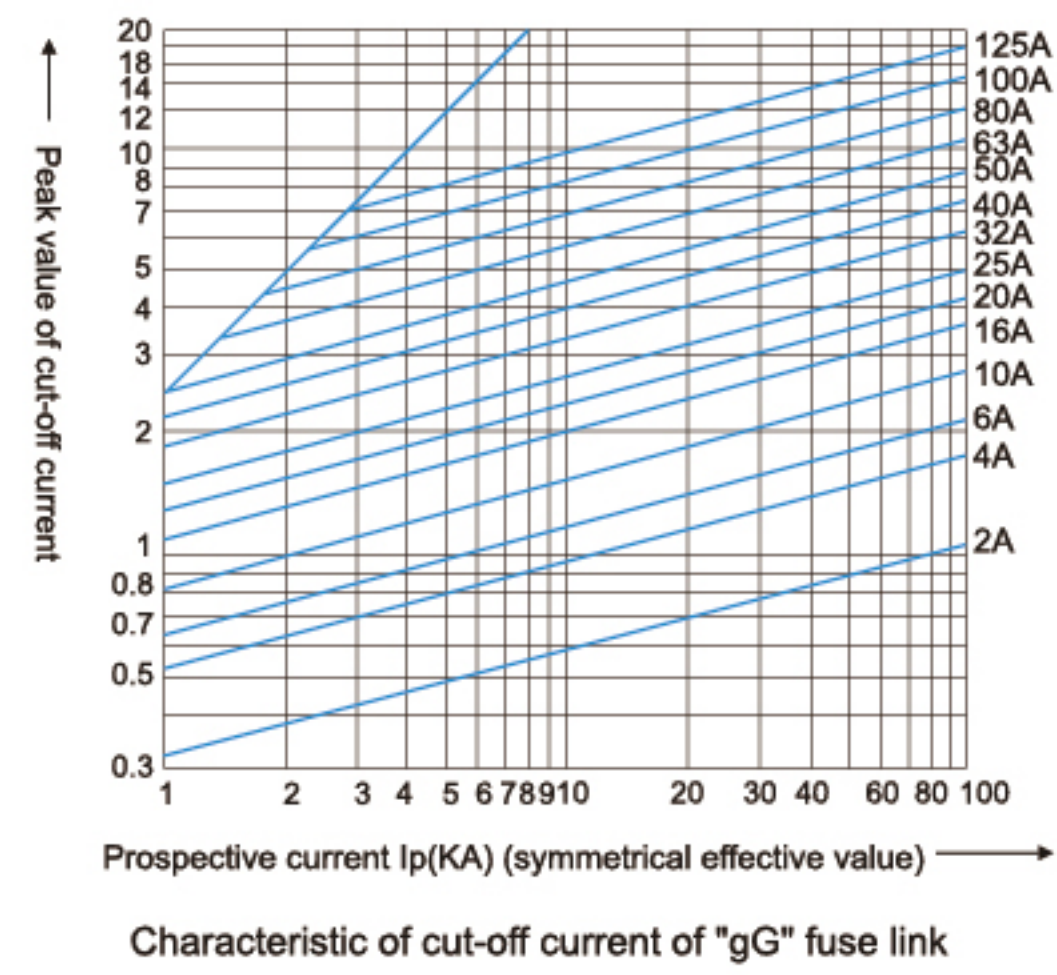
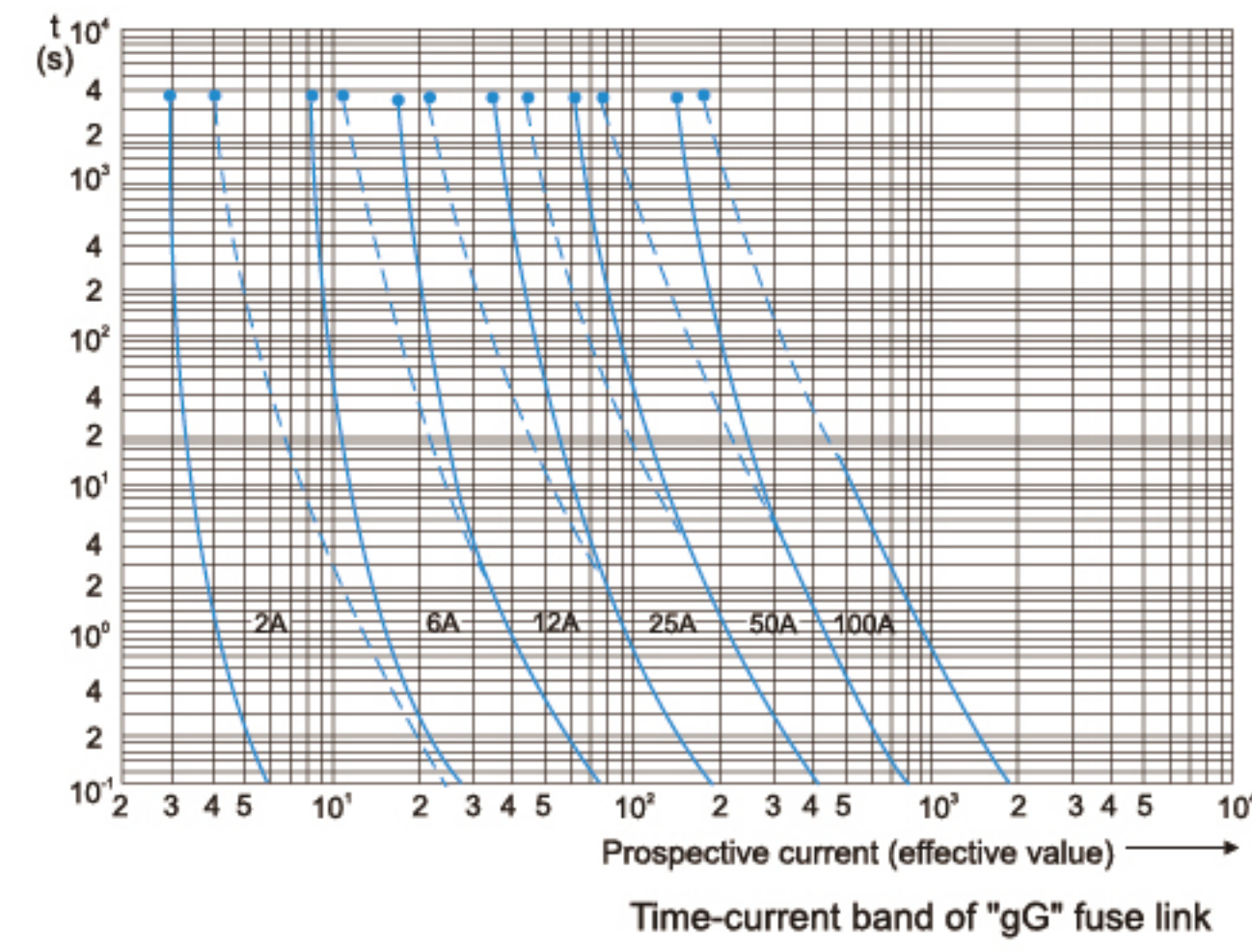
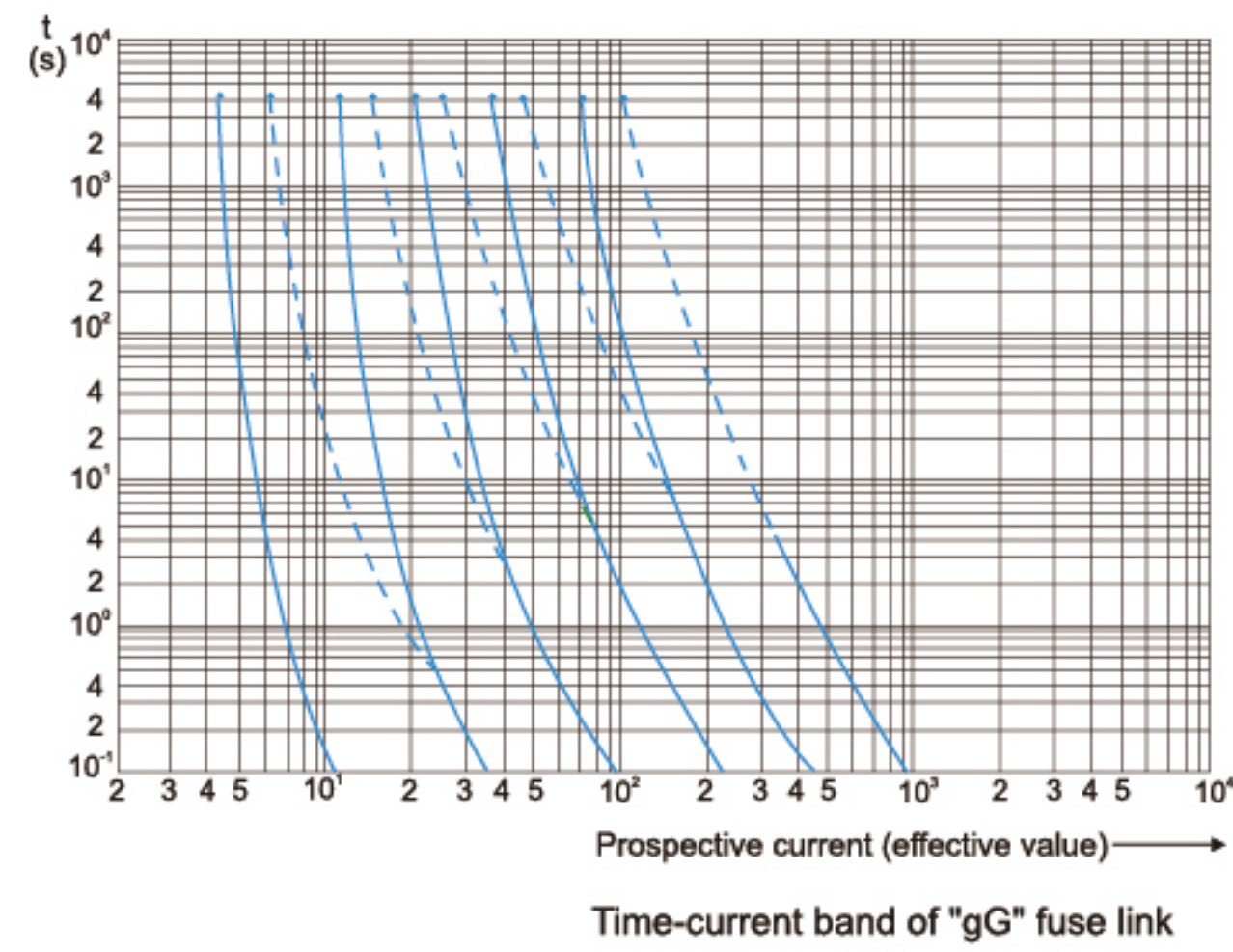

## 6.Order Note

Following items should be marked when ordering	Ordering sample
Product name and model	To order EBS1TR thermal relay, rated current is 25A, setting current range is 18A, quantity is 1000 pieces, should be marked: Thermal relay EBS1TR-25/18 1000pcs
Rated current	
Setting current range	
Quantity	